

# BITUFLAME - 250

Torch applied APP modified bitumen waterproofing membrane  
4mm thick reinforced with heavy duty non-woven polyester mat

## DESCRIPTION

Bituflame 250 is torch applied membrane manufactured from APP modified distilled bitumen, reinforced with a core non-woven spunbonded polyester fabric, rot-proof and flexible. The polyester gives the membrane its excellent mechanical properties, allows for high tensile, elongation and tear strength.

## ADVANTAGES

- Positive barrier to water ingress and dampness
- Excellent resistance to aging and weathering
- Flexibility at low temperatures
- Stability at high temperatures
- High tensile strength and tear resistance
- Accommodates structural movements
- Fast, easy and clean application



## USES

To avoid damp and water leakage risk, it's recommended for:

- Concrete roof and floor slabs
- Basements
- Foundations
- Swimming Pools
- Fountains
- Drain Gutters
- Bathrooms
- Reservoirs
- Bridges
- Tunnels
- Sub-grade structures
- Car Park Deck Slabs

## SPECIFICATION

The waterproofing membrane complies with the requirements of ASTM D 6222 type II, Grade 5, UEAtc MOAT 30, DIN 52133. International Standards.

### Certificates

The manufacturing facility is certified with the ISO 9001:2015 QMS, GMP, ISO 14001 EM and ISO 45001 OH & S

## Technical Data

PROPERTIES	RESULTS	UNIT	TEST METHOD
Thickness	4 ±0.2	mm	ASTM D-5147
Length	10	M	ASTM D-5147
Width	1	M	ASTM D-5147
Mass/unit area	> 4.0	Kg/m <sup>2</sup>	ASTM D-5147
Coating Asphalt: Type	APP Modified Asphalt		
Softening Point (Ring & Ball)	>150	°C	ASTM D-36
Penetration	12 to 25	dmm	ASTM D-5
Bottom Side Coating Thickness	> 1.0	mm	ASTM D-5147
Tensile strength (L&T) @23±2 °C	1100/900	N/5cm	DIN 52123 UEAtc M.O.A.T. 30 ASTM D 5147
Elongation(L&T) @23±2°C	45/50	%	ASTM D-5147 UEAtc M.O.A.T. 30
Peak Load @23± 2°C	> 14	KN/m	ASTM D-5147
Tear resistance(L&T) @23±2°C	700/650	N	ASTMD-4073 ASTM D-5147
Lap joint strength (L&T)	1100/900	N/5cm	UEAtc M.O.A.T. 30 &27
Load strain product: (L&T) @23± 2°C	49500 / 45000		CGSB-37 GP 56M
Puncture Resistance	>1050	N	ASTM E 154
Puncture Resistance	Static : L4 Dynamic : 14		UEAtc M.O.A.T. 27
Hydrostatic pressure @ 5-bar (72.5 psi)	No Leakage		ASTM D-5147
Resistance to Aging after 2000 hours (Accelerated Weathering Tester)	No deterioration		ASTM D 4799
Heat Resistance for 2-hours	NoFlow @ 135°C	°C	ASTM D-5147 UEAtc M.O.A.T. 30
Cold Flexibility	0to -7	°C	ASTM D-5147
Dimension Stability(L&T)	± 0.5	%	ASTM D-5147
Water absorption	<3.2	%	ASTM D-5147
Moisture content	< 0.5	%	ASTM D-5147
Appearance	No defects,holes, tears, cracks, blisters		

The information given in this data sheets is the average of test of various samples conducted under lab conditions. \*In accordance to ASTM and UEAtc Standards results are subjected to 5 to 20% tolerance.

## THICKNESS

Membrane available in different thicknesses (3, 4, 5, 6 mm)



# BITUFLAME - 250

Torch applied APP modified bitumen waterproofing membrane  
4mm thick reinforced with heavy duty non-woven polyester mat

## INSTRUCTION TO USE

### SURFACE CLEANING

All surfaces should be smooth, clean and dry. To make sure it is cleaned from nails, grease, dust, debris, oil, protruding elements etc.

### PRIMING

Apply one coat of primer and we recommend using Bituprimer, Seal Coat D41 or Aquaproof. Allow primer coat to dry until it is tack free. Prior to the application of the membrane, all surfaces must be re-primed if left for more than 24 hours.

### APPLICATION

The membrane is unrolled and placed in the correct position. Each roll must side overlap at least 10 cm, while slowly unrolling the membrane the surface is lightly heated by means of a propane gas torch causing surface melting and subsequent adhesion to the surface. End joints should be made with a minimum of 15 cm overlap.

### APPLICATION TOOLS AND EQUIPMENT

- Propane gas torch with related gas cylinder
- Knife/cutter
- Trowel with a rounded tip
- Marking Aids
- Measuring Tape
- Fire Extinguisher



# HEALTH, SAFETY AND ENVIRONMENT

All safety measures should be observed during application. Fire extinguishers should be available on site. Care should be taken with gas, and torches should not be rested on finished surface or on any materials that can be scratched by flame or hot torch. Gloves and goggles should be worn by all workers during application.

Read, understand and follow all Material Safety Data Sheets and product label information for this product prior to use.

### STORAGE

- Keep the products packed in a dry place.
- Keep away from direct sunlight.
- Do not place the pallets on top of each other.
- Rolls must always be kept in a vertical position.

### TECHNICAL SUPPORT

International Insulation Company (IIC) - Bitugulf technical support team consist of expert engineers offers a comprehensive service support to specifiers, end users and contractors, and on-site technical assistance

### INTERNATIONAL INSULATION COMPANY (BITUGULF) Factory

Western Shuaiba Industrial, Block (3), Building (90),  
Opposite of Kuwait Steel Co.  
Telephone: (+965) 23262824 (Factory)  
(+965) 90019846 / 90019917 / 96600332 (Sales)  
Email: info@bitugulf.net

### Showroom

Shuwaikh Industrial, Block (A), Building (139),  
Opposite to Hyundai Maintenance Center  
Telephone: (+965) 24912765 / 94122711  
Email: showroom@bitugulf.net

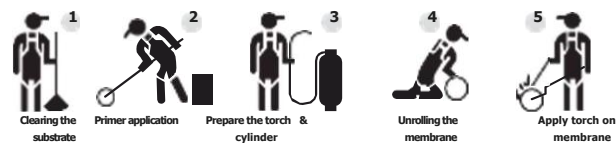

**Note:** The technical data provided reflects typical properties based on laboratory tests and practical experience, subject to UEAtc tolerance levels. While we cannot guarantee performance under all conditions, further details are available upon request, with a standard variation of up to 20%.

