

BITUFLAME - 60200

Torch applied APP modified bitumen waterproofing membrane
6mm thick, reinforced with 200 gsm non-woven polyester mat

DESCRIPTION

Bituflame-60200 is torch applied membrane manufactured from APP modified distilled bitumen, reinforced with a core of non-woven spunbonded polyester fabric, weighing 200- gsm, rot-proof and flexible. The polyester gives the membrane its excellent mechanical properties, allows for high tensile, elongation, and tear strength. The chemical resistance of Bituflame-60200 makes it suitable for tanking applications where aggressive ground water conditions dominate.

ADVANTAGES

- Positive barrier to water ingress and dampness
- Excellent resistance to aging & weathering
- Flexibility at low temperatures
- Stability at high temperatures
- High tensile strength & tear resistance
- Accommodates structural movements
- Fast, easy and clean application



USES

To avoid damp & water leakage risk, it's recommended for:

- Concrete roof and floor slabs
- Basements
- Foundations
- Swimming pools
- Fountains
- Drain gutters
- Bathrooms
- Reservoirs
- Bridges
- Tunnels
- Sub-grade structures
- Car park deck slabs

SPECIFICATION

The waterproofing membrane is a high-performance torch applied 6 mm thick APP membrane, manufactured from high quality polymer modified bituminous compounds and reinforced with non-woven polyester. The waterproofing membrane Complies with the requirements of ASTM D 6222 type II, grade S, UEAtc MOAT 30, DIN 52133.

Technical Data

PROPERTIES	RESULTS	TEST METHOD
Roll Size	1 x 7 (mtr)	ASTM – D 5147
Thickness	6 (mm)	ASTM – D 5147
Mass per unit area	6 (Kg/m ²)	ASTM – D 5147
Reinforcement	200 (g/m ²)	UEAtc. M.O.A. T.31
Coating Material	APP Modified Bitumen	As standard
Softening Point (R&B)	>155 °C	ASTM – D 36, UEAtc
Penetration at 23 ± 2 °C	12 to 25 - dmm	ASTM – D 5, UEAtc
Tensile Strength (L&T) 23 ± 2 °C	1150 (N/5cm)	UEAtc method and DIN52123
	950 (N/5cm)	UEAtc method and DIN52123
Elongation at break (L&T) 23 ± 2 °C	50%	UEAtc method and DIN52123
	50%	UEAtc method and DIN52123
Tear Resistance (L&T) 23 ± 2 °C	750 (N)	ASTM – D 4073
	650(N)	ASTM – D 4073
Overlap Joint Test (L&T)	1150 (N/5cm)	UEAtc method and DIN52123
	950 (N/5cm)	UEAtc method and DIN52123
Puncture Resistance	1050 (N)	ASTM – E 154
Hydrostatic Pressure@5-bar	No Leakage	ASTM – D 5147
Water Absorption	<3.2(%)	ASTM–D6222 M-11
Heat Resistance for 2 hours	No Flow at 135 °C	ASTM – D 5147
Cold Flexibility	No Crack @ -10 °C	ASTM – D 5147
Dimension Stability (L & T)	± 0.5 (%)	ASTM – D 5147

The information given in this data sheets is the average of test of various samples conducted under lab conditions.
*In accordance to ASTM and UEAtc Standards results are subjected to 5 to 20% tolerance.



BITUFLAME - 60200

Torch applied APP modified bitumen waterproofing membrane
6mm thick, reinforced with 200 gsm non-woven polyester mat

INSTRUCTION TO USE

SURFACE CLEANING

All surfaces should be smooth, clean and dry. To make sure it cleaned from nails, grease, dust, debris, oil, protruding elements etc.

PRIMING

Apply one coat of the recommended primer and we recommend using Bituprimer, SealCoat-D41 or Aquaproof. Allow the primer coat to dry until it is tack free. Prior to the application of the membrane, all surfaces must re-primed if left for more than 24 hours.

APPLICATION

The membrane is unrolled and placed in the correct position. Each roll must side overlap at least 10-cm while slowly unrolling the membrane the surface is lightly heated by means of a propane gas torch causing surface melting and subsequent adhesion to the surface. End joints should be made with a minimum of 15-cm overlap.

APPLICATION TOOLS AND EQUIPMENT

- Propane gas torch with related gas cylinder
- Knife/cutter
- Trowel with a rounded tip
- Protective gloves and goggles
- Marking aids
- Measuring tape
- Fire extinguisher



HEALTH, SAFETY AND ENVIRONMENT

All safety measures should be observed during application. Fire extinguishers should be available at site. Care should be taken with gas, and torch should not be rested on finished surface or on any materials that can be scratched by flame or hot torch. Gloves and goggles should be worn by all workers during application.

Read, understand and follow all Material Safety Data Sheets and product label information for this product prior to use.

STORAGE

- Keep the products packed in a dry place.
- Keep away from direct sunlight.
- Do not place the pallets one on top of another
- Rolls must always be kept in a vertical position.

TECHNICAL SUPPORT

International Insulation Company (IIC) - Bitugulf technical support team consist of expert engineers offers a comprehensive service support to specifiers, end users and contractors, and on-site technical assistance.

INTERNATIONAL INSULATION COMPANY (BITUGULF) Factory

Western Shuaiba Industrial, Block (3), Building (90),
Opposite of Kuwait Steel Co.

Telephone: (+965) 23262824 (Factory)

(+965) 90019846 / 90019917 / 96600332 (Sales)

Email: info@bitugulf.net

Showroom

Shuwaikh Industrial, Block (A), Building (139),
Opposite to Hyundai Maintenance Center

Telephone: (+965) 24912765 / 94122711

Email: showroom@bitugulf.net

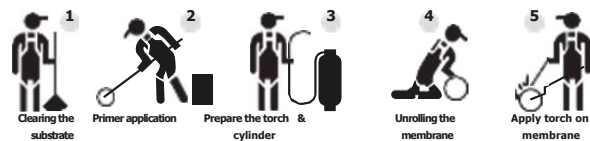

Note: The technical data provided reflects typical properties based on laboratory tests and practical experience, subject to UEAtc tolerance levels. While we cannot guarantee performance under all conditions, further details are available upon request, with a standard variation of up to 20%.