

BITUFLAME - SL

Torch applied APP modified bitumen waterproofing membrane reinforced with polyester complies with ASTM D - 6222 Type II Grade G

DESCRIPTION

Bituflame SL is high performance waterproofing membrane, produced with a layer of natural slate flakes on weathering side to protect the membrane from UV radiation and ageing. Produced in highly controlled process, the reinforcement made of non-woven spunbonded polyester and straight run bitumen modified with selected APP polymers and stabilizers.

FEATURES

- Positive barrier to water and dampness
- Excellent resistance to ageing and atmospheric agents
- Accommodates structural movements
- Designed for use in exposed system
- Provided with lap strip
- Resistant to water-born chemical attack
- Stability at high temperatures
- Excellent puncture and tear resistance
- Excellent resistance to UV rays, aging and weathering
- Easy for application and repair works



USES

Bituflame SL is ideal to use for new and re-roofing applications. It can be used in almost every waterproofing application which includes roofs, balconies, basements, reservoirs, bridges, tunnels, lining for sewage canals, sub-grade structures etc.

STANDARDS

Complies with the requirements of ASTM D - 6222 Type II Grade G

Certificates

The manufacturing facility is certified with the ISO 9001:2015 QMS, GMP ISO 14001 EM and ISO 45001 O H & S .

THICKNESS

Membrane available in different thicknesses (3,4, 5, 6 mm)

Technical Data

PROPERTIES	TYPICAL RESULTS	TEST METHOD
Appearance	Nodefects,holes, tears, cracks or blisters	ASTM D-5147
Roll Size, m	10 x 1	ASTM D-5147
Thickness min., mm	4	ASTM D-5147
Mass per unit area min. (g/m ²)	4882	ASTM D-5147
Bottom sidecoating thickness min. mm	1.0	ASTM D-5147
Peak load at 23 ± 2 °C (L/T) before and after heat conditioning, KN/m minimum	14	ASTM D-5147
Elongation at 23 ± 2 °C (L/T) before and after heat conditioning, at peak load, % minimum	40/45	ASTM D-5147
Peak load at -18 ± 2 °C (L/T), KN/m, minimum	15.8	ASTM D-5147
Elongation at -18 ± 2 °C (L/T), at peak load, % minimum	15	ASTM D-5147
Elongation at 5% of Maximum load at 23 ± 2 °C (L/T), % minimum	50	ASTM D-5147
Tear strength at 23 ± 2 °C N, minimum	356	ASTM D-5147
Low temperature flexibility, before and after heat conditioning in °C, maximum	0	ASTM D-5147
Dimensional stability % change, maximum	1	ASTM D-5147
Compound stability, °C minimum	120	ASTM D-5147
Granule embedment, maximum loss, grams	2	ASTM D-5147
Water absorption, % maximum	3.2	ASTM D-5147
Moisture content, % maximum	<1	ASTM D-5147
Low temperature unrolling, °C maximum	5	ASTM D-5147

The information given in this data sheets is the average of test of various samples conducted under lab conditions. *In accordance to ASTM and UAE standards results are subjected to 5 to 20% tolerance.

PRIMING

Apply one coat of the recommended primer and we recommend using Sealcoat D41. Allow the primer coat to dry until it is tack free. Prior to application of the membrane, all surfaces must be re-primed if left more than 24 hours.



BITUFLAME - SL

Torch applied APP modified bitumen waterproofing membrane reinforced with polyester complies with ASTM D - 6222 Type II Grade G

INSTRUCTION TO USE

SURFACE CLEANING

The surface must be thoroughly cleaned and should be free from dust, debris, oil and protruding elements.

FIXING INSTRUCTION

The installation should start from one edge/end of the surface. Unroll one roll over the surface with minimum 10 cm side lap alignment. Fixing should be either loose laid or fully bonded.

Loose Laid

Re-roll the unrolled membrane to a length suitable for application without changing the orientation. Melt minimum 10 cm from the edges. Fix the melt portion firmly to the pre-primed surface. Position the subsequent rolls, give edge overlapping of minimum 10 cm, side overlapping of minimum 10 cm and continue until the area is fully fixed. The melted compound should be spread with a trowel or roller to ensure a smooth tight seal.

Fully Bonded

Melt the lower surface of the membrane with a gas torch by moving the flame across the entire width of the roll. Fix the melt portion firmly to the pre-primed surface. The subsequent rolls should be done in the same manner as of loose laid membrane.

APPLICATION TOOLS AND EQUIPMENT

- Propane gas torch with related gas cylinder
- Knife / Cutter
- Trowel with a rounded tip
- Protective gloves and goggles
- Marking aids
- Measuring tape
- Fire extinguisher



HEALTH, SAFETY AND ENVIRONMENT

All safety measures should be observed during application. Fire extinguishers should be available on site. Care should be taken with gas, and torch should not be rested on finished surface or on any materials that can be scratched by flame or hot torch. Gloves and goggles should be worn by all workers during application.

Read, understand and follow all Material Safety Data Sheets and product label information for this product prior to use.

STORAGE

- Keep the products packed in a dry place.
- Keep away from direct sunlight.
- Do not place the pallets on top of each other.
- Rolls must always be kept in a vertical position.

TECHNICAL SUPPORT

International Insulation Company (IIC) - Bitugulf technical support team consist of expert engineers offers a comprehensive service support to specifiers, end users and contractors, and on-site technical assistance.

INTERNATIONAL INSULATION COMPANY (BITUGULF)

Factory

Western Shuaiba Industrial, Block (3), Building (90),
Opposite of Kuwait Steel Co.

Telephone: (+965) 23262824 (Factory)

(+965) 90019846 / 90019917 / 96600332 (Sales)

Email: info@bitugulf.net

Showroom

Shuwaikh Industrial, Block (A), Building (139),

Opposite to Hyundai Maintenance Center

Telephone: (+965) 24912765 / 94122711

Email: showroom@bitugulf.net

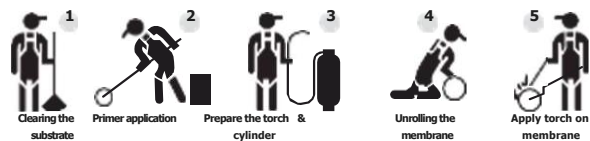

Note: The technical data provided reflects typical properties based on laboratory tests and practical experience, subject to UEAtc tolerance levels. While we cannot guarantee performance under all conditions, further details are available upon request, with a standard variation of up to 20%.

