

BITUFLEX - 2000

Torch applied SBS modified bitumen waterproofing membrane
4mm thick, reinforced with non-woven polyester mat

DESCRIPTION

Bituflex-2000 is torch applied membrane manufactured from SBS modified distilled bitumen, reinforced with a core of non-woven polyester fabric, rot-proof and flexible.

The polyester gives the membrane its excellent mechanical properties, allows for high tensile, Elongation, and tear strength.

The chemical resistance of Bituflex-2000 makes its suitable for tanking applications where aggressive ground water conditions dominate.

ADVANTAGES

- Positive barrier to water ingress and dampness
- Excellent resistance to aging & weathering
- Flexibility at low temperature
- Stability at high temperature
- High tensile strength & tear resistance
- Accommodates structural movements
- Fast, easy and clean application

SPECIFICATION

Bituflex 2000 waterproofing membrane complies with the requirements of ASTM D 6164 Type II, Grade S.

Certificates

Manufacturing facility is certified with the ISO 9001:2015 QMS, GMP, ISO 14001 EM and ISO 45001 OH & S.



USES

To avoid damp & water leakage risk, it's recommended for:

- Concrete roof and floor slabs
- Basements
- Foundations
- Swimming pools
- Fountains
- Drain gutters
- Bathrooms
- Reservoirs
- Bridges
- Tunnels
- Sub grade structures

Technical Data

PROPERTIES	RESULTS	UNIT	TEST METHOD
Thickness	4 ± 0.2	mm	ASTM D-5147
Length	10	m	ASTM D-5147
Width	1	m	ASTM D-5147
Mass/unit area	4.2 ± 0.2	Kg/m ²	ASTM D-5147
Softening Point (Ring & Ball)	>110	°C	ASTM D-36
Penetration	20 to 35	dmm	ASTM D-5
Tensile strength (L&T) @ 23°C ±2	>900/800	N/5cm	DIN52123UEAtc M.O.A.T.30
Elongation (L&T) @ 23°C ±2	45/50	%	DIN52123UEAtc M.O.A.T.30
Tear resistance(L&T) @ 23°C ±2	600/500	N	ASTMD-4073ASTM D-5147
Overlap joint test (L&T) @ 23°C ±2	900/800	N/5cm	DIN52123UEAtc M.O.A.T.30 &27
Load Strain Product (L/T)	40500/40000		CGSB-37 GP 56 M
Puncture Resistance	>900	N	ASTM E 154
Puncture Resistance	Static:L3 Dynamic : I3		UEAtc M.O.A.T.30 &27
Hydrostatic pressure @ 5-bar	No Leakage		ASTM D-5147
Resistance to Water pressure 2 bar (29 psi)	No Leakage		DIN 52123
Heat Resistance for 2-hours	NoFlow @ 100	°C	ASTM D-5147
Cold Flexibility	>18	°C	ASTM D-5147
Dimension Stability(L&T)	± 0.5	%	ASTM D-5147
Water Absorption @ 23° 24 -hours	<0.25	%	ASTM D-5147

THICKNESS

Different thicknesses (3,4,5,6 mm) are available upon request.

The information given in this data sheets is the average of test of various samples conducted under lab conditions. *In accordance to ASTM and UEAtc Standards results are subjected to 5 to 20% tolerance.



BITUFLEX - 2000

Torch applied SBS modified bitumen waterproofing membrane
4mm thick, reinforced with non-woven polyester mat

INSTRUCTION TO USE

SURFACE PREPARATION

All surfaces should be smooth and free from all harmful objects and thoroughly cleaned, from (nails, grease, dust, debris, oil, protruding elements etc.)

PRIMING

Apply liberal coat of the recommended primer and we recommend using Bituprimer allowed primer coat to dry until it is tack free. Prior to the application of the membrane. All surfaces must re-primed if left for more than 24 hours.

APPLICATION

The membrane is unrolled and placed in the correct position where it is to be torched on later. Each roll must side overlap at least 10-cm while slowly unrolling the membrane the surface is lightly heated by means of a propane gas torch causing surface melting and subsequent adhesion to the surface. End joints should be made with a minimum of 15-cm overlap.

APPLICATION TOOLS AND EQUIPMENT

- Propane gas torch with related gas cylinder
- Knife/ cutter
- Trowel with round tip
- Protective gloves and goggles
- Marking aids
- Measuring tape
- Fire extinguisher



HEALTH, SAFETY AND ENVIRONMENT

All safety measures should be observed during application. Fire extinguishers should be available at site. Care should be taken with gas, and torch should not be rested on finished surface or on any materials that can be scratched by flame or hot torch. Gloves and goggles should be worn by all workers during application.

Read, understand and follow all Material Safety Data Sheets and product label information for this product prior to use.

STORAGE

- Keep the products packed in a dry place.
- Keep away from direct sunlight.
- Do not place the pallets on top of each other.
- Rolls must always be kept in a vertical position.

TECHNICAL SUPPORT

International Insulation Company (IIC) - Bitugulf technical support team consist of expert engineers offers a comprehensive service support to specifiers, end users and contractors, and on-site technical assistance.

INTERNATIONAL INSULATION COMPANY (BITUGULF)

Factory

Western Shuaiba Industrial, Block (3), Building (90),
Opposite of Kuwait Steel Co.
Telephone: (+965) 23262824 (Factory)
(+965) 90019846 / 90019917 / 96600332 (Sales)
Email: info@bitugulf.net

Showroom

Shuwaikh Industrial, Block (A), Building (139),
Opposite to Hyundai Maintenance Center
Telephone: (+965) 24912765 / 94122711
Email: showroom@bitugulf.net

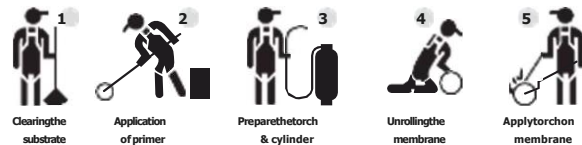

Note: The technical data provided reflects typical properties based on laboratory tests and practical experience, subject to UEAtc tolerance levels. While we cannot guarantee performance under all conditions, further details are available upon request, with a standard variation of up to 20%.

