

# BITUROOF- 200

Torch applied APP modified bitumen waterproofing membrane  
4mm thick reinforced with non-woven polyester mat

## DESCRIPTION

Bituroof 200 membrane is designed with a superior grade of select bitumen, APP polymers, additives and spun bonded non-woven polyester reinforcement, exhibiting a high performance of waterproofing characteristics meeting the diversified demand of waterproofing application in construction industry.

Bituroof 200 membrane forms an impervious waterproof blanket and withstands normal structural movement.

## ADVANTAGES

- High tensile strength and elongation to withstand dynamic movement in structure.
- High impact strength, tear and puncture resistance.
- Flexibility at low temperatures.
- Stability at high temperatures.
- Resistance towards salts and water-borne chemicals.
- Outstanding bonding ability and seam integrity, fast, easy and clean application.



## SPECIFICATION

Bituroof 200 waterproofing membrane complies with the requirements of ASTM D 6222 type II, Grade S and UEAtc MOAT 30, DIN 52133, International standards.

### Certificates

The Manufacturing facility is certified with the ISO 9001:2015 QMS, GMP, ISO 14001 EM and ISO 45001 OH & S

## THICKNESS

Membrane available in different thicknesses (3,4, 5, 6 mm)

## Technical Data

PROPERTIES	TYPICAL RESULTS	TEST METHOD
Appearance	Nodefects,holes, tears, cracks or blisters	ASTM D-5147
Roll Size, m	10 x 1	ASTM D-5147
Thickness, mm	4 ± 0.2	ASTM D-5147
Mass per unit area min. (g/ m <sup>2</sup> )	4505	ASTM D-5147
Bottom side coating thickness min. mm	1.0	ASTM D-5147
Tensile Strength, N/5cm (L/T) at 23 ± 2 °C	850/700	ASTM D-5147 UEAtc M.O.A.T.30
Lap Joint Strength, N/5cm (L/T)	850/700	UEAtc M.O.A.T. 30&27
Elongation at 23 ± 2 °C (L/T) before and after heat conditioning, at peak load, % minimum	45/45	ASTM D-5147
Tear strength at 23±2°C N, minimum	650/550	ASTM D-5147
Low temperature flexibility, before and after heat conditioning in °C	0 to -5	ASTM D-5147
Dimensional stability % change, maximum	1	ASTM D-5147
Compound stability, in °C minimum	120	ASTM D-5147
Water absorption, % maximum	3.2	ASTM D-5147
Moisture content, % maximum	<1	ASTM D-5147
Low temperature unrolling, in °C maximum	5	ASTM D-5147

The information given in this data sheets is the average of test of various samples conducted under lab conditions.  
\*In accordance to ASTM and UEAtc Standards results are subjected to 5 to 20% tolerance.

## USES

To avoid damp and water leakage risk, it's recommended for:

- Concrete roof and floor slabs
- Basements
- Foundations
- Swimming Pools
- Fountains
- Drain Gutters
- Bathrooms
- Reservoirs
- Bridges
- Tunnels
- Sub-grade structures
- Car Park Deck Slabs



# BITUROOF - 200

Torch applied APP modified bitumen waterproofing membrane  
4mm thick reinforced with non-woven polyester mat

## INSTRUCTION TO USE

### SURFACE CLEANING

All surfaces should be smooth, clean and dry.  
To make sure it is cleaned from nails, grease,  
dust, debris, oil, protruding elements etc.

### PRIMING

Apply one coat of primer and we recommend using Bituprimer. Allow  
the primer coat to dry until it is tack free. Prior to the application of the  
membrane, all surfaces must be re-primed if left for more than 24 hours.

### APPLICATION

The membrane is unrolled and placed in the correct position. Each roll  
must side overlap at least 10 cm, while slowly unrolling the membrane  
the surface is lightly heated by means of a propane gas torch causing  
surface melting and subsequent adhesion to the surface. End joints  
should be made with a minimum of 15 cm overlap.

### APPLICATION TOOLS AND EQUIPMENT

- Propane gas torch with related gas cylinder
- Knife/cutter
- Trowel with a rounded tip
- Marking Aids
- Measuring Tape
- Fire Extinguisher



# HEALTH, SAFETY AND ENVIRONMENT

All safety measures should be observed during application. Fire  
extinguishers should be available on site. Care should be taken with  
gas, and torches should not be rested on finished surface or on any  
materials that can be scratched by flame or hot torch. Gloves and  
goggles should be worn by all workers during application.

Read, understand and follow all Material Safety Data Sheets and  
product label information for this product prior to use.

### STORAGE

- Keep the products packed in a dry place.
- Keep away from direct sunlight.
- Do not place the pallets on top of each other's.
- Rolls must always be kept in a vertical position.

### TECHNICAL SUPPORT

International Insulation Company (IIC) - Bitugulf technical support team  
consist of expert engineers offers a comprehensive service support to  
specifiers, end users and contractors, and on-site technical assistance.

### INTERNATIONAL INSULATION COMPANY (BITUGULF) Factory

Western Shuaiba Industrial, Block (3), Building (90),  
Opposite of Kuwait Steel Co.

Telephone: (+965) 23262824 (Factory)

(+965) 90019846 / 90019917 / 96600332 (Sales)

Email: info@bitugulf.net

### Showroom

Shuwaikh Industrial, Block (A), Building (139),

Opposite to Hyundai Maintenance Center

Telephone: (+965) 24912765 / 94122711

Email: showroom@bitugulf.net

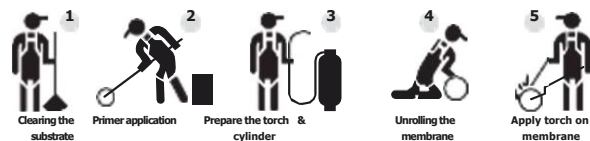

**Note:** The technical data provided reflects typical properties based on laboratory tests and practical experience, subject to UEAtc tolerance levels. While we cannot guarantee performance under all conditions, further details are available upon request, with a standard variation of up to 20%.