

# OXIDIZED

Torch applied APP modified bitumen waterproofing membrane reinforced with a core of non-woven polyester fabric, rot-proof and flexible

## DESCRIPTION

Oxidized is torch applied membrane manufactured from APP modified bitumen, reinforced with a core of non-woven spun bonded polyester fabric, rot-proof and flexible.

The polyester gives the membrane its excellent mechanical properties, allows for high tensile, elongation and tear strength.

The chemical resistance Oxidized makes it suitable for tanking applications where aggressive ground water conditions dominate.

## ADVANTAGES

- Positive barrier to water ingress and dampness
- Good resistance to aging and weathering
- Stability at high temperatures
- High tensile strength and tear resistance
- Accommodates structural movements
- Fast, easy and clean application



## USES

- Concrete roof and floor slabs
- Basements
- Foundations
- Swimming Pools
- Fountains
- Drain Gutters
- Bathrooms
- Reservoirs
- Bridges
- Tunnels
- Sub-grade structures
- Car Park Deck Slabs

## THICKNESS

We produce different thicknesses (3,4,5,6mm) are available upon request.

## Technical Data

| PROPERTIES                    | TYPICAL RESULTS                            | TEST METHOD |
|-------------------------------|--|-------------|
| Appearance                    | No defects, holes, tears, cracks, blisters | ASTM D 5147 |
| Thickness                     | >3.7 mm                                    | ASTM D 5147 |
| Width                         | 1 meter                                    | ASTM D 5147 |
| Bottom Side Coating Thickness | >0.8 mm                                    | ASTM D 5147 |
| Net mass per unit area        | 3700 g/m <sup>2</sup>                      | ASTM D 5147 |
| Peak load at 23 ±2°C          | 10 KN/m                                    | ASTM D 5147 |
| Elongation at 23 ±2°C         | 35%  | ASTM D 5147 |
| Tear strength at 23 ±2°C      | >70 N                                      | ASTM D 4073 |
| Dimensional stability         | 0.5%                                       | ASTM D 5147 |
| High temperature stability    | 120°C                                      | ASTM D 5147 |
| Water absorption              | <3.2%                                      | ASTM D 5147 |
| Moisture content              | 0.5%                                       | ASTM D 5147 |

The information given in this data sheets is the average of test of various samples conducted under lab conditions. \*In accordance to ASTM and UEAtc Standards results are subjected to 5 to 20% tolerance.

## SPECIFICATION

Oxidized waterproofing membrane complies with the requirements of ASTM D 6222 type I, Grade S, UEAtc MOAT 30, DIN 52133 International Standards.

Approvals / Certificates

Product Manufactured in Kuwait.

Manufacturing facility is certified with the ISO 9001:2015 QMS, GMP, ISO 14001 Environmental Management and ISO 45001 Occupational Health and Safety Management System.



# OXIDIZED

Torch applied APP modified bitumen waterproofing membrane reinforced with a core of non-woven polyester fabric, rot-proof and flexible

## INSTRUCTION TO USE

### SURFACE CLEANING

All surfaces should be smooth, clean and dry. To make sure it is cleaned from nails, grease, dust, debris, oil, protruding elements etc.

### PRIMING

Apply one coat of primer and we recommend using Bituprimer. Allow the primer coat to dry until it is tack free. Prior to the application of the membrane, all surfaces must be re-primed if left for more than 24 hours.

### APPLICATION

The membrane is unrolled and placed in the correct position. Each roll must side overlap at least 10 cm, while slowly unrolling the membrane the surface is lightly heated by means of a propane gas torch causing surface melting and subsequent adhesion to the surface. End joints should be made with a minimum of 15 cm overlap.

### STORAGE

- Keep the products packed in a dry place.
- Keep away from direct sunlight.
- Do not place the pallets on top of each other.
- Rolls must always be kept in a vertical position.



# HEALTH, SAFETY AND ENVIRONMENT

All safety measures should be observed during application. Fire extinguishers should be available at site. Care should be taken with gas, and torches should not be rested on finished surface or on any materials that can be scratched by flame or hot torch. Gloves and goggles should be worn by all workers during application.

Read, understand and follow all Material Safety Data Sheets and product label information for this product prior to use.

### TECHNICAL SUPPORT

International Insulation Company (IIC) - Bitugulf technical support team consist of expert engineers offers a comprehensive service support to specifiers, end users and contractors, and on-site technical assistance.

### INTERNATIONAL INSULATION COMPANY (BITUGULF)

#### Factory

Western Shuaiba Industrial, Block (3), Building (90),  
Opposite of Kuwait Steel Co.  
Telephone: (+965) 23262824 (Factory)  
(+965) 90019846 / 90019917 / 96600332 (Sales)  
Email: info@bitugulf.net

#### Showroom

Shuwaikh Industrial, Block (A), Building (139),  
Opposite to Hyundai Maintenance Center  
Telephone: (+965) 24912765 / 94122711  
Email: showroom@bitugulf.net

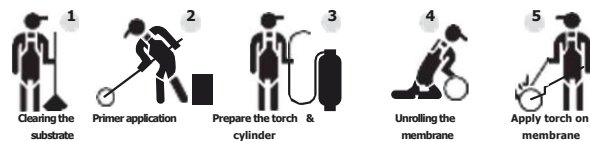

**Note:** The technical data provided reflects typical properties based on laboratory tests and practical experience, subject to UEAtc tolerance levels. While we cannot guarantee performance under all conditions, further details are available upon request, with a standard variation of up to 20%.