

SOOR AL KUWAIT

Torch applied APP modified bitumen waterproofing membrane
4mm thick reinforced with non-woven polyester mat

DESCRIPTION

Soor Al Kuwait is torch applied membrane manufactured from APP modified distilled bitumen, reinforced with a non-woven spunbonded polyester fabric, rot-proof and flexible. The polyester gives the membrane its excellent mechanical properties, allows for high tensile, elongation and tear strength. The chemical resistance of SOOR Al Kuwait makes it suitable for tanking applications where aggressive ground water conditions dominate.

ADVANTAGES

- Positive barrier to water ingress and dampness
- Excellent resistance to aging and weathering
- Flexibility at low temperatures
- Stability at high temperatures
- High tensile strength and tear resistance
- Accommodates structural movements
- Fast, easy and clean application

SPECIFICATION

SOOR Al Kuwait waterproofing membrane complies with the requirements of ASTM D 6222 type II, Grade S, UEAtc MOAT 30, DIN 52133 International Standards.

Certificates

The Manufacturing facility is certified with the ISO 9001:2015 QMS, GMP, ISO 14001 EM and ISO 45001 OH & S.

USES

To avoid damp and water leakage risk, it's recommended for:

- Concrete roof and floor slabs
- Basements
- Foundations
- Swimming Pools
- Fountains
- Drain Gutters
- Bathrooms
- Reservoirs
- Bridges
- Tunnels
- Sub-grade structures
- Car Park Deck Slabs



Technical Data

| PROPERTIES | RESULTS | UNIT | TEST METHOD |
|---|--|-------------------|---|
| Thickness | 4 ±0.2 | mm | ASTM D-5147 |
| Length | 10 | Meter | ASTM D-5147 |
| Width | 1 | Meter | ASTM D-5147 |
| Mass/unit area | 4.2 ±0.2 | Kg/m ² | ASTM D-5147 |
| Coating Asphalt Type | APP Modified Asphalt | | |
| Softening Point (Ring & Ball) | >155 | °C | ASTM D-36 |
| Penetration | 12 to 25 | dmm | ASTM D-5 |
| Bottom Side Coating Thickness | > 1 | mm | ASTM D-5147 |
| Tensile strength (L&T) @23±2°C | 1000/700 | N/5cm | DIN 52123 UEAtc M.O.A.T. 30 ASTM D 5147 |
| Peak Load @23±2°C | 20/14 | KN/m | ASTM D-5147 |
| Elongation(L&T) @23±2°C | 45/50 | % | ASTM D-5147 UEAtc M.O.A.T.30 |
| Elongation (L&T) 5 % of maximum load@23±2°C | 50/50 | % | ASTM D-5147 |
| Tear resistance (L&T) @23±2°C | 625/500 | N | ASTMD-4073 ASTM D-5147 |
| Lapjoint strength (L&T) | 1000/700 | N/5cm | UEAtc M.O.A.T. 30 & 27 |
| Puncture Resistance | 900 | N | ASTM E 154 |
| Hydrostatic pressure@5-bar (72.5 psi) | No Leakage | | ASTM D-5147 |
| Heat Resistance for 2-hours | No Flow @ 120°C | °C | ASTMD-5147UEAtc M.O.A.T. 30 |
| Cold Flexibility | 0 to -5 °C | °C | ASTM D-5147 |
| Dimension Stability(L&T) | ± 0.5 | % | ASTM D-5147 |
| Water absorption | <3.2 | % | ASTM D-5147 |
| Moisture content | < 0.5 | % | ASTM D-5147 |
| Appearance | No defects, holes, tears, cracks, blisters | | |

The information given in this data sheets is the average of test of various samples conducted under lab conditions. *In accordance to ASTM and UEAtc Standards results are subjected to 5 to 20% tolerance.

THICKNESS

We produce different thicknesses (3, 4, 5 mm) are available upon request.



SOOR AL KUWAIT

Torch applied APP modified bitumen waterproofing membrane
4mm thick reinforced with non-woven polyester mat

INSTRUCTION TO USE

SURFACE CLEANING

All surfaces should be smooth, clean and dry. To make sure it is cleaned from nails, grease, dust, debris, oil, protruding elements etc.

PRIMING

Apply one coat of primer and we recommend using Bituprimer. Allow the primer coat to dry until it is tack free. Prior to the application of the membrane, all surfaces must be re-primed if left for more than 24 hours.

APPLICATION

The membrane is unrolled and placed in the correct position. Each roll must side overlap at least 10 cm, while slowly unrolling the membrane the surface is lightly heated by means of a propane gas torch causing surface melting and subsequent adhesion to the surface. End joints should be made with a minimum of 15 cm overlap.

APPLICATION TOOLS AND EQUIPMENT

- Propane gas torch with related gas cylinder
- Knife/cutter
- Trowel with a rounded tip
- Marking Aids
- Measuring Tape
- Fire Extinguisher



HEALTH, SAFETY AND ENVIRONMENT

All safety measures should be observed during application. Fire extinguishers should be available on site. Care should be taken with gas, and torches should not be rested on finished surface or on any materials that can be scratched by flame or hot torch. Gloves and goggles should be worn by all workers during application.

Read, understand and follow all Material Safety Data Sheets and product label information for this product prior to use.

STORAGE

- Keep the products packed in a dry place.
- Keepaway from direct sunlight.
- Do not place the pallets on top of each other.
- Rolls must always be kept in a vertical position.

TECHNICAL SUPPORT

International Insulation Company (IIC) - Bitugulf technical support team consist of expert engineers offers a comprehensive service support to specifiers, end users and contractors, and on-site technical assistance.

INTERNATIONAL INSULATION COMPANY (BITUGULF)

Factory

Western Shuaiba Industrial, Block (3), Building (90),

Opposite of Kuwait Steel Co.

Telephone: (+965) 23262824 (Factory)

(+965) 90019846 / 90019917 / 96600332 (Sales)

Email: info@bitugulf.net

Showroom

Shuwaikh Industrial, Block (A), Building (139),

Opposite to Hyundai Maintenance Center

Telephone: (+965) 24912765 / 94122711

Email: showroom@bitugulf.net

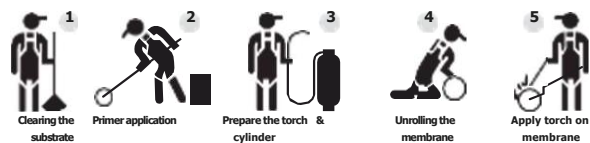

Note: The technical data provided reflects typical properties based on laboratory tests and practical experience, subject to UEAtc tolerance levels. While we cannot guarantee performance under all conditions, further details are available upon request, with a standard variation of up to 20%.

